



# BEST OF FEIN PRODUCT CATALOG



# OSCILLATING

FEIN invented the oscillating multitool in 1967 and has been perfecting its design, functionality, and performance ever since. Backed by **150 years** of innovation and German-engineering, our MULTIMASTER provides various levels of performance classes so you get the power you need and the quality that FEIN is known for.



PERFORMANCE  
CLASS

## MULTIMASTER 500

ALL AROUND GREAT PERFORMANCE

- + Long-life, 350 watt German-made motor
- + Variable speed control optimizes cutting performance
- + Best in class vibration dampening
- + StarlockPlus blade mount so you can choose from over 160 Starlock and StarlockPlus accessories
- + Ultra fast QuickIN blade change
- + Oscillating range: 2 x 1.7°



MADE IN  
GERMANY



### MULTIMASTER MM 500 START

**PART NUMBER:** 72295264090

**KIT INCLUDES:** 1 MM 500, 24 accessories, 1 nylon tool case



### MULTIMASTER MM 500 PLUS TOP

**PART NUMBER:** 72296770090

**KIT INCLUDES:** 1 MM 500, 31 accessories, 1 L-Boxx pro tool case



PERFORMANCE  
CLASS

## MULTIMASTER 700

THE PRO'S CHOICE

- + Long-life, 450 watt German-made motor
- + Widest range of variable speed control for precise control
- + StarlockMax blade mount: flexibility to choose from over 180 Starlock, StarlockPlus, and StarlockMax accessories
- + Best in class vibration dampening
- + Ultra fast QuickIN blade change
- + Oscillating range: 2 x 2.0° for faster cutting performance



MADE IN  
GERMANY



### MULTIMASTER MM 700 MAX BASIC

**PART NUMBER:** 72296863090

**KIT INCLUDES:** 1 MM 700, 1 accessory, 1 L-Boxx pro tool case



### MULTIMASTER MM 700 MAX TOP

**PART NUMBER:** 72296864090

**KIT INCLUDES:** 1 MM 700, 31 accessories, 1 L-Boxx pro tool case



Powered by  **BOSCH**



### **18V CORDLESS MULTIMASTER 500 SELECT**

**PART NUMBER:** 71293862090

**SELECT TOOL BUNDLE INCLUDES:** 1 AMM500,  
1 accessory, 1 L-Boxx pro tool case



### **18V CORDLESS MULTIMASTER 500 PLUS KIT 2 Ah**

**PART NUMBER:** 71293865090

**KIT INCLUDES:** 1 AMM500, 1 2Ah CORE 18V battery, 1 Fast charger,  
18 accessories, 1 nylon bag



### **18V CORDLESS MULTIMASTER 500 TOP KIT 4Ah**

**PART NUMBER:** 71293861090

**KIT INCLUDES:** 1 AMM500, 2 4Ah CORE 18V batteries,  
1 Fast charger, 31 accessories, 1 L-Boxx pro tool case



### **18V CORDLESS MULTIMASTER 500 PLUS KIT 4 Ah**

**PART NUMBER:** 71293866090

**KIT INCLUDES:** 1 AMM500, 1 4Ah CORE 18V battery, 1 Fast charger,  
18 accessories, 1 nylon bag



### **18V CORDLESS MULTIMASTER 700 SELECT**

**PART NUMBER:** 71293662090

**SELECT TOOL BUNDLE INCLUDES:** 1 AMM700,  
1 accessory, 1 L-Boxx pro tool case



### **18V CORDLESS MULTIMASTER 700 PLUS KIT 4 Ah**

**PART NUMBER:** 71293664090

**KIT INCLUDES:** 1 AMM700, 1 4Ah CORE 18V battery, 1 Fast charger,  
18 accessories, 1 nylon bag



### **18V CORDLESS MULTIMASTER 700 MAX TOP KIT 4Ah**

**PART NUMBER:** 71293661090

**KIT INCLUDES:** 1 AMM700, 2 4Ah CORE 18V batteries, 1 Fast charger,  
60 accessories, 1 L-Boxx pro tool case

# OSCILLATING ACCESSORIES

FEIN offers the right solution for thousands of professional applications, for all FEIN oscillating multi-tools and the most common multifunctional tools on the market. Find the perfect accessory that is right for your project.

## STARLOCK FITS THE MOST BRANDS OF ANY OSCILLATING PLATFORM.



● Fits    ● Fits but requires adapter    ● Does not fit

Bosch - 2015 & Newer - Starlock	●
FEIN Starlock Models	●
Festool	●
Flex	●
Makita - 2021 & Newer (cordless)	●
Metabo - 2021 & Newer	●
Bauer	●
Bosch - Pre 2015 - OIS Interface	●
Craftsman - Pre 2019	●
FEIN - All Legacy Models - Pre 2015	●
Hitachi (Now Metabo HPT)	●
Kobalt	●
Makita - Pre 2021 Non-Starlock	●
Metabo - Pre 2020	●
Milwaukee	●
Ridgid	●
Rockwell	●
Ryobi	●
Skill	●
Worx	●
Craftsman - 2020 & Newer	●
DeWalt	●
Porter Cable	●
FEIN - Legacy Supercut Models - Pre 2015	●
Dremel	●

Achieve precise, high-quality cuts at top speeds with our German engineered blades. Designed to fit a variety of oscillating multitools, Starlock blades will help you get the most out of your multitool.



## STARLOCK BLADES OFFER THE QUICKEST & SAFEST BLADE CHANGE SYSTEM!



To release the blade, lift the locking lever...



Blade will simply drop out. Close the locking lever...



then simply position the new blade in the Starlock mount & click into place. **Ready to go!**

**NEVER TOUCH A HOT BLADE AGAIN!**



## OMT ACCESSORIES



Part Number	Description
92602102000	Dust extraction accessory set, fits current 300, 500 & 700 series tools
32127069010	Depth stop for Starlock blades

## SANDING



Part Number	Description	Pack Size	Blade Type
35222967280	Best of Starlock Sanding kit	63	Sanding
63810031010	Profile sanding set SLP	22	Sanding
63717109035	50 pack assorted perforated sanding sheet set (60,80,120,180,240 grit)	50	Sanding
63806159220	Sanding pad SL finger shape 2-Pack	2	Sanding
63717109013	60 Grit abrasive sheet - Finger	50	Sanding
63717186019	80 Grit abrasive sheet - Finger	20	Sanding
63717188011	120 Grit abrasive sheet - Finger	20	Sanding
63806136220	Perforated backing pad set	2	Sanding
63717110043	80 Grit abrasive sheet - Perf Paper	5	Sanding
63717110015	80 Grit abrasive sheet - Perf Paper	50	Sanding
63717112045	120 Grit abrasive sheet - Perf Paper	5	Sanding
63717112017	120 Grit abrasive sheet - Perf Paper	50	Sanding
63717113049	150 Grit abrasive sheet - Perf Paper	5	Sanding
63717113011	150 Grit abrasive sheet - Perf Paper	50	Sanding
63717114047	180 Grit abrasive sheet - Perf Paper	5	Sanding
63717114019	180 Grit abrasive sheet - Perf Paper	50	Sanding
63717116044	240 Grit abrasive sheet - Perf Paper	5	Sanding
63717116016	240 Grit abrasive sheet - Perf Paper	50	Sanding

## SPECIALTY BLADES



Part Number	Description	Pack Size	Blade Type
63502118210	SL Saw blade Segmented	1	Grout/Tile
63731001210	SL Rasp triangle shape TC 80	1	Grout/Tile
63731002210	SLP Rasp finger shape TC	1	Grout/Tile
63903165210	SL Flexible scraper	1	Scraping Soft Material
63903226210	SL Rigid scraper blade	1	Scraping Hard Material
63903245230	SL Cutter blade mushroom	5	Caulk Removal
63903251260	SL Multi Blade	1	Roofing/Vinyl
63706019210	SL File TC	1	Carbon Fiber/Wood
63502114210	Segmented Diamond Saw Blade	1	Hard Grouts/Epoxy Resin

# OSCILLATING ACCESSORIES

FEIN offers the right solution for thousands of professional applications, for all FEIN oscillating multi-tools and the most common multifunctional tools on the market. Find the perfect accessory that is right for your project.

## GENERAL PURPOSE BLADES



### E-CUT PRECISION BIM SAW BLADE

Bi-metal with double-row of HSS Japanese teeth for all wood materials, drywall and soft plastics. Fastest cutting speed and maximum precision.



### E-CUT STANDARD - CURVED

Set teeth for all wood, drywall and plastic materials. Curved geometry for optimal plunge cutting.



### E-CUT LONG LIFE

Bi-metal with HSS teeth for all wood, drywall and plastic materials. Robust and resistant to nails in wood, masonry, etc.



### E-CUT UNIVERSAL

Bi-metal with wavy HSS universal teeth. For sheet metal up to 1/16 in, aluminum, copper pipes, wood, drywall and plastics.



### E-CUT CARBIDE PRO

Wear-resistant carbide teeth for hard metals such as tempered screws and high-strength machine screws. Also for abrasive materials such as brick, masonry, cement fiber slabs & laminate.

## MULTI-MATERIAL BLADES

Part Number	Description	Blade Width	Pack Size	Blade Type
63502106210	Saw blade SL segmented HSS	3-11/32"	1	3/4 Round - Clean Wood
63502176210	Saw blade SLP round wood BIM	3-15/16"	1	RND - Multi Material
63502205270	Saw blade SL E-Cut precision BIM	1-3/8"	3	JPN Tooth Multi Material
63502205290	Saw blade SL E-Cut precision BIM	1-3/8"	10	JPN Tooth Multi Material
63502229270	Saw blade SL E-Cut precision BIM	2-1/2"	3	JPN Tooth Multi Material
63502229290	Saw blade SL E-Cut precision BIM	2-1/2"	10	JPN Tooth Multi Material
63502227270	Saw blade SL E-Cut curved HCS	1-3/8"	3	Curved - Wood/Drywall
63502225270	Saw blade SL E-Cut curved HCS	2-1/2"	3	Curved - Wood/Drywall
63502225290	Saw blade SL E-Cut curved HCS	2-1/2"	10	Curved - Wood/Drywall

## DEMO BLADES

**MADE IN GERMANY**

Part Number	Description	Blade Width	Pack Size	Blade Type
63502160270	Saw blade SL E-Cut Long Life BIM	1-3/8"	3	All Material Demo
63502160290	Saw blade SL E-Cut Long Life BIM	1-3/8"	10	All Material Demo
63502221270	Saw blade SL E-Cut Long Life BIM	2"	3	All Material Demo
63502228270	Saw blade SL E-Cut Long Life BIM	2-1/2"	3	All Material Demo
63502228290	Saw blade SL E-Cut Long Life BIM	2-1/2"	10	All Material Demo

## METAL CUTTING BLADES

**MADE IN GERMANY**

Part Number	Description	Blade Width	Pack Size	Blade Type
63502152270	Saw blade SLP E-Cut Universal BIM	1-3/8"	3	Metal/Universal
63502152290	Saw blade SLP E-Cut Universal BIM	1-3/8"	10	Metal/Universal
63502223270	Saw blade SL E-Cut Universal BIM	1-3/4"	3	Metal/Universal
63502223290	Saw blade SL E-Cut Universal BIM	1-3/4"	10	Metal/Universal
63502157270	Saw blade SL E-Cut Fine	1-1/8"	3	FINE Metal
63502157290	Saw blade SL E-Cut Fine	1-1/8"	10	FINE Metal
63502236260	Saw blade SL E-Cut metal Carbide Pro	1-1/4"	1	Heavy/Hard Metal
63502236270	Saw blade SL E-Cut metal Carbide Pro	1-1/4"	3	Heavy/Hard Metal
63502236290	Saw blade SL E-Cut metal Carbide Pro	1-1/4"	10	Heavy/Hard Metal



## EXTREME PERFORMANCE CARBIDE & DIAMOND BLADES\*



### DIAMOND SAW BLADE

The especially robust saw blade with a long service life for extremely hard joint materials, including waterproof epoxy resin grouts in swimming pools.



### CARBIDE SAW BLADE

The economical alternative for removing marble, epoxy resin, and trass joints, and cutting grooves in plaster, porous concrete, and similar construction materials.

Part Number	Description	Pack Size	Blade Type
63903241210	Carbide Grit - Special Shape	1	Grout/Tile
63903243210	Diamond Grit - Special Shape	1	Hard Grouts/ Epoxy Resin

\*For use with (A)MM700 tools only

**NEW!**

## EXTREME PERFORMANCE BLADES\*

**MADE IN GERMANY**



Part Number	Description	Blade Width	Pack Size	Blade Type
63502203220	3" XL SLM E-Cut Long Life blade BIM	1-5/8"	3	XL Reach Demo
63502203240	3" XL SLM E-Cut Long Life blade BIM	1-5/8"	10	XL Reach Demo
63502224260	3-1/2" SLM XL E-Cut Long Life blade BIM	1-1/4"	1	XXL Reach Demo
63502224290	3-1/2" SLM XL E-Cut Long Life blade BIM	1-1/4"	10	XXL Reach Demo
63502238220	3" saw blade SLM E-Cut metal Carbide Pro	1-1/4"	3	XL Reach Hard Metal

\*For use with (A)MM700 tools only

## BULK PACK BLADES

**MADE IN GERMANY**



Part Number	Description	Blade Width	Pack Size	Blade Type
63502160250	SL E-Cut Long Life Saw Blade	1-3/8"	50	Demo
63502223250	SL E-Cut Universal Saw Blade	1-3/4"	50	Metal/Universal
63502151250	SLP E-Cut Universal Saw Blade	1-1/8"	50	Metal/Universal
63502152250	SLP E-Cut Universal Saw Blade	1-3/8"	50	Metal/Universal

## BLADE KITS



Part Number	Description	Pack Size	Blade Type
35222967010	Best of Starlock WOOD & METAL Kit	6	Wood/Metal
35222967290	Combo Starlock RENOVATION PRO	3	Reno
35222967300	E-Cut Combo Starlock WOOD	3	Wood
35222967060	Best of Starlock RENOVATION	26	Reno
35222952140	E-Cut saw blade Combo SL 3-Pack	3	Wood/Metal
35222942080	Best of E-Cut SLP WOOD & METAL	6	Wood/Metal

# SPECIALTY OSCILLATING

The FEIN 1.7 series oscillating tool offers uncompromising performance for demanding applications and all day use.

**MADE IN GERMANY**



**MM 700 1.7**  
+ Hex blade attachment for efficient power transmission



**(A)MM 700 1.7 Q**  
+ Quick change hex blade attachment for efficient power transmission

## ALL 1.7 TOOLS FEATURE

- + 2 x 1.7° Oscillations
- + German-made motor
- + Solid metal head for superior durability
- + Low vibration for all day use
- + Electronic variable speed control



**MULTIMASTER 700 1.7 CAULKING SET**  
**PART NUMBER:** 72297162090  
**KIT INCLUDES:** 1 MM700 1.7, 7 accessories, 1 L-Boxx pro tool case



**MULTIMASTER 700 1.7Q AUTOGLASS**  
**PART NUMBER:** 72297065090  
**KIT INCLUDES:** 1 MM700 1.7Q, 14 accessories, 1 L-Boxx pro tool case



**18V CORDLESS MULTIMASTER 700 1.7Q AUTOGLASS**  
**PART NUMBER:** 71293762090  
**KIT INCLUDES:** 1 AMM700 1.7Q, 2 4Ah CORE 18V batteries, 1 Fast charger, 14 accessories, 1 L-Boxx pro tool case



## CAULKING CUTTER BLADES



### SEGMENT BLADE

For V-cuts and for cuts in corners, 1-1/4" blade length, 2-pack

**PART NUMBER:**  
63903132010



### DIAMOND SEGMENT BLADE

Diamond-coated, for corners 3/32". For marble and cement mortar

**PART NUMBER:**  
63903162017



### CLEANING BLADE

Diamond-coated, for cleaning mortar flanks before refilling, 5-pack

**PART NUMBER:**  
63903161030



### MUSHROOM BLADE

For cutting elastic silicon or acrylic connecting joints as well as for separation of insulating glass. 5-pack

**PART NUMBER:**  
63903128012



### CUTTER BLADE

Elongated pointed blade for very deep joints, 5-pack

**PART NUMBER:**  
63903116011  
**NEW!**  
**XL VERSION**  
**PART NUMBER:**  
63903271020



### STRAIGHT CUTTER BLADE

Universal blade for removal of almost all expansion joints, 5-pack

77MM **PART NUMBER:**  
63903117015  
**NEW!**  
90MM **XL VERSION**  
**PART NUMBER:**  
63903270030

## AUTOGLASS BLADES



### U-SHAPED CUTTING BLADE

For removal glass from behind the hood. Reinforced design, serrated, 2-pack

**PART NUMBER:**  
63903212018



### L-SHAPED CUTTING BLADE

Serrated, 2-pack

**PART NUMBER:**  
63903209014



### L-SHAPED CUTTING BLADE

Serrated, 2-pack

**PART NUMBER:**  
63903208010



### L-SHAPED CUTTING BLADE

Serrated, 2-pack

**PART NUMBER:**  
63903207012



### U-SHAPED CUTTING BLADE

Ideal for glass removal from behind the hood. Reinforced design, 2-pack

**PART NUMBER:**  
63903157011



### U-SHAPED CUTTING BLADE

Ideal for glass removal from behind the hood. Reinforced design, 2-pack

**PART NUMBER:**  
63903111019

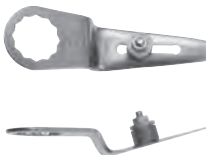

### STRAIGHT CUTTING BLADE

Z-bend, with adjustable depth stop, 2-pack

**PART NUMBER:**  
63903143013



### STRAIGHT CUTTING BLADE

Suitable for removal of attached body parts.

Z-bend, serrated, 2-pack

**PART NUMBER:**  
63903081013

# PREMIUM VACUUMS

FEIN Dust Extractors are designed to be more efficient than traditional shop vacuums and leave your work area spotless. Coupled with FEIN's quiet, powerful operation, long hoses and power cords, and accessories for connecting a variety of power tools, you can rely on our FEIN TURBO dust extractors.

## TURBO I, TURBO II & TURBO II X AC

### EFFECTIVE DUST CONTROL

The 1 micron standard filtration system and a .3 micron HEPA filtration system (on select models) provides best in class particulate removal.

### IMPRESSIVE SUCTION

98.4 static water lift (245 mbar) of vacuum and a 151 cfm (71 L/s) flow rate at the blower ensures powerful suction and fast dust extraction.



### SENSIBLE STORAGE

Rimmed storage features cable hose hooks.

### AUTOSTART OUTLET

Quickly starts when attached tool is switched on and runs briefly after shut down to clear hose of remaining dust.

### SUPERIOR MOBILITY

Easy to maneuver with large, 360 degree wheels.

## TURBO ACCESSORIES

**Non-woven filter bag**  
5 pack



Part Number  
Turbo I 31345061010

**Non-woven filter bag**  
5 pack



Part Number  
Turbo II 31345062010

**Non-woven filter bag, premium**  
5 pack



Part Number  
Turbo II 31345251010

**HEPA filter bag**  
3 pack



Part Number  
31345130010

**Cellulose flat pleated filter**



Part Number  
31345012010

**Flat pleated filter PES**



Part Number  
31345059010

**HEPA flat pleated filter**



Part Number  
31345060010

**HEPA flat pleated filter - TURBO X AC**



Part Number  
31345274010

**Anti-static suction hose**  
13 ft length.



Part Number  
1-3/8 in dia 31345120010

**Tool coupling with suction control**



Part Number  
1-3/8 in dia 31345300010

**Accessory set for FEIN vacuum cleaners**

Consisting of: 2 metal suction tubes, 1 combination tool with interchangeable inserts, 1 crevice nozzle, 1 dusting brush, 1 elbow



**BEST VALUE**

Part Number  
31345071020

**Step adapter**



Part Number  
31345079010

**Dusting brush**



Part Number  
31345076010

**Upholstery nozzle**



Part Number  
31345075010

**Crevice nozzle**



Part Number  
31345074010

## ALL VACUUMS FEATURE

- + 1,100 Watt (9 Amp) power
- + 151 CFM Air volume
- + 98.4 inches of static water lift
- + 13 ft long vacuum hose
- + Quiet operation
- + Extra long 19 ft power cord
- + Autostart outlet with power-on delay



### **TURBO I** Wet/Dry Dust Extractor

- PART NUMBER:** 92035236090
- + 5.8 gallon capacity
  - + 1 micron filtration



**NEW!**

### **TURBO I HEPA PRO SET** Wet/Dry Dust Extractor

- PART NUMBER:** 92037060990
- + 5.8 gallon capacity
  - + .3 micron filtration
  - + HEPA certified
  - + Includes hoses & tool attachments



### **TURBO II** Wet/Dry Dust Extractor

- PART NUMBER:** 92036236090
- + 8.5 gallon capacity
  - + 1 micron filtration



**NEW!**

### **TURBO II HEPA PRO SET** Wet/Dry Dust Extractor

- PART NUMBER:** 92036060990
- + 8.5 gallon capacity
  - + .3 micron filtration
  - + HEPA certified
  - + Includes hoses & tool attachments



### **TURBO II X AC HEPA PRO SET** Wet/Dry Dust Extractor

- PART NUMBER:** 92030070990
- + 9.2 gallon capacity
  - + .3 micron filtration
  - + HEPA certified
  - + Autoclean function
  - + Variable speed
  - + Includes hoses & tool attachments

# WHAT IS AMPSHARE?

**AMPShare - Powered by Bosch** is a power source that works across expert brands, allowing various applications to be powered by one battery system.

## AMP SHARE BATTERIES & CHARGERS



**CORE 18V 2.0Ah A**  
**PART NUMBER:**  
92604344030



**CORE 18V AS 4.0 Ah**  
**PART NUMBER:**  
92604341030



**CORE 18V AS 8.0 Ah**  
**PART NUMBER:**  
92604342030



**CORE 18V AS 12.0 Ah**  
**PART NUMBER:**  
92604343030



**CORE 18V AS STARTER SET 2.0 Ah**  
**PART NUMBER:** 92604244090



**CORE 18V AS STARTER SET 4.0 Ah**  
**PART NUMBER:** 92604228090



**CORE 18V AS STARTER SET 8.0 Ah**  
**PART NUMBER:** 92604229090



**CORE 18V AS STARTER SET 12.0 Ah**  
**PART NUMBER:** 92604241090



**14.4-18V AS Fast Charger**  
**PART NUMBER:** 92604334010  
Best for 2.0Ah & 4.0Ah batteries



**18V AS Turbo Charger**  
**PART NUMBER:** 92604338010  
Best for 4.0Ah, 8.0Ah & 12Ah batteries

## AMP SHARE ADVANTAGES AT A GLANCE

### EXPANDED COMPATIBILITY

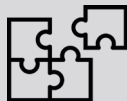

AMPShare™ batteries and chargers are compatible with Bosch 18V power tools and with cordless products part of the multi-brand AMPShare™ Alliance.

11

### LEADING BATTERY & CHARGER TECHNOLOGY



Within AMPShare™, batteries with CORE18V® technology offer a high-performance record, heat management technology, and an optimal power-to-weight ratio to power the toughest work. To keep power-ready, AMPShare™ offers both fast and faster charging solutions.

### PROFESSIONAL EXPERTISE



All members of the AMPShare™ Alliance are leading expert brands in their field committed to meeting the highest demands of trade and industry.

### COMPLETE FLEXIBILITY

Use the same battery for the new cordless MULTIMASTER AS with AMPShare interface and for all 18V cordless devices with AMPShare or Bosch Professional 18V battery interface.

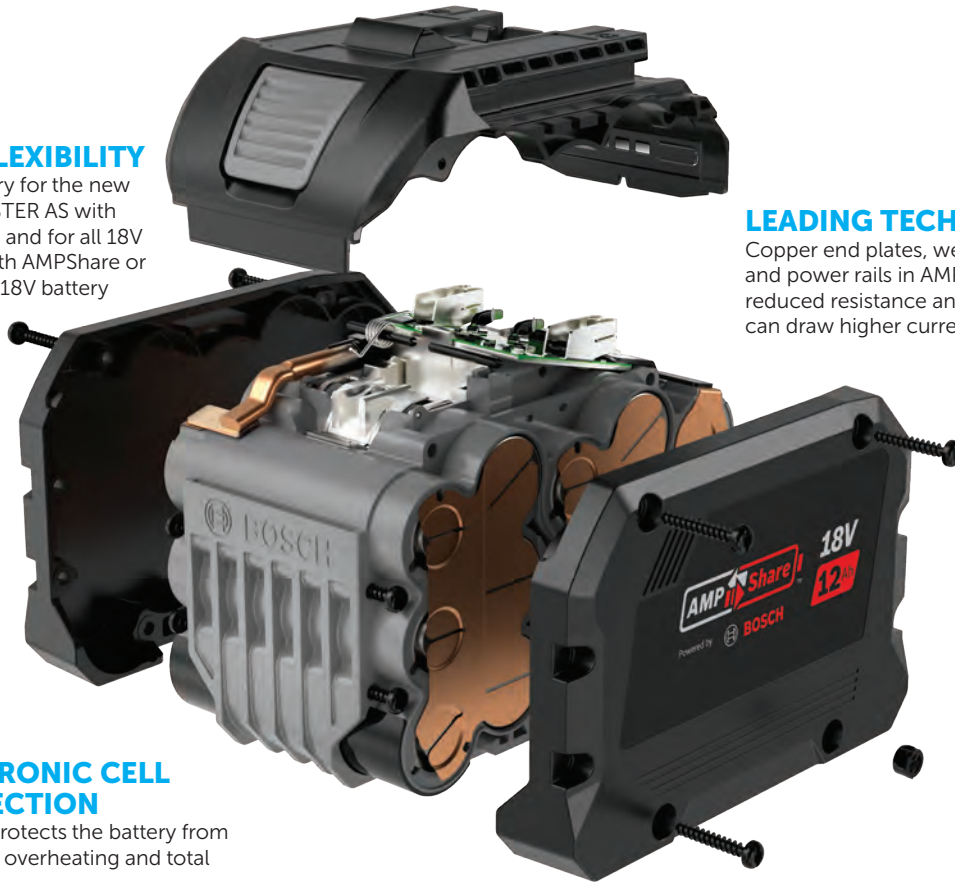

### LEADING TECHNOLOGY

Copper end plates, welded cell connectors and power rails in AMPShare batteries provide reduced resistance and greater efficiency, so tools can draw higher currents over a longer time.

### ELECTRONIC CELL PROTECTION

Reliably protects the battery from overload, overheating and total discharge.

### COOLPACK 2.0 TECHNOLOGY

4 Ah, 8Ah and 12Ah Batteries are equipped with CoolPack technology that delivers longer life for batteries with better heat management to protect the cells from damage.

Each cell is housed in its own heat sync with no air gaps between cells for better heat dissipation. More surface area on the shell provides better heat transfer to the outer surface.

### FASTER THAN EVER CHARGING

The new AMPShare Fast Charger helps avoid downtime by charging batteries in a fraction of the time compared to conventional battery and chargers. The AS Fast Charger charges 4Ah batteries to 80% in 32 minutes and 2Ah batteries in just 15 minutes which means you don't have to slow down just because your battery does.

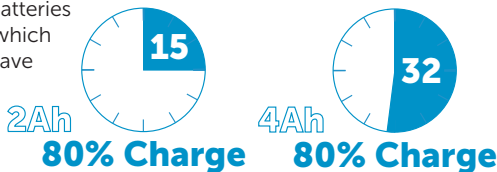

### SAVINGS WITH ONE SYSTEM



AMPShare™ alleviates the need to invest in multiple battery platforms by offering compatibility with different brands and their cordless tools.

### EASIER BATTERY MANAGEMENT

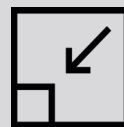

AMPShare™ reduces the clutter and complexity of managing and working with multiple battery and charger solutions.

### A GROWING NETWORK



AMPShare™ batteries today will be compatible with even more tools from even more brands in the future.

# GRINDING

With an impressive lineup of metalworking tools, its no wonder the pros turn to FEIN when they need quality, durable grinders that can stand the test of time.

## **WSG 7 SERIES - 7 AMP**

- + Compact ergonomic grip
- + Paddle switch with dead-man function and slide switch models available
- + Solid metal drive head rotates in 90° increments, no plastic components



**WSG 7-115**  
4-1/2" slide switch grinder  
**PART NUMBER:**  
72219760120



**WSG 7-115 PT**  
4-1/2" paddle switch grinder  
**PART NUMBER:**  
72223160120

## **CG 10 SERIES - 10 AMP**

- + Dust protection grille
- + Paddle switch with dead-man function
- + Solid metal drive head rotates in 90° increments, no plastic components
- + 4-1/2" and 5" models



**CG 10-115PDEV**  
4-1/2" paddle switch grinder  
Variable speed:  
2,700-10,500 RPM  
**PART NUMBER:**  
72225960120



**CG10-115PDE**  
4-1/2" paddle switch grinder  
**PART NUMBER:**  
72226060120



**CG10-125PDE**  
5" paddle switch grinder  
**PART NUMBER:**  
72226160120

## **CG 13 SERIES - 13 AMP**

- + Dust protection grille
- + Paddle switch with dead-man function and slide switch models available
- + Solid metal drive head rotates in 90° increments, no plastic components
- + Robust guard system & antivibration handle
- + 5" and 6" models



**CG13-150 SS**  
6" slide switch grinder  
**PART NUMBER:**  
72228361090



**CG13-125PDE**  
5" paddle switch grinder  
**PART NUMBER:**  
72226460120



**CG13-150PDEV**  
6" paddle switch grinder  
Variable speed:  
2,500-9,500 RPM  
**PART NUMBER:**  
72226260120



**CG13-150PDE**  
6" paddle switch grinder  
**PART NUMBER:**  
72226360120

# A RADICALLY IMPROVED CONCEPT.

**NEW**

CG 15 – The first of its class to include a brushless FEIN PowerDrive fully enclosed motor. Available with paddle switch or slide switch.

**MADE IN GERMANY**

## LIGHT BUT POWERFUL

Best weight/performance ratio at 4.8lbs. and 1,050W output power. Significantly higher efficiency than an angle grinder with 1,700W rated input.

## EXTREME DURABILITY

Sealed electronic components protect the unit from damaging grinding dust. Overload protection is built in to lead to fewer breakdowns and longer tool life.

## READY FOR ANY APPLICATION:

The infinitely variable electronic speed - ideal for a wide range of abrasives and applications.

## NEW! ADVANCED MOTOR TECHNOLOGY

Completely enclosed brushless FEIN PowerDrive motor with optimized air flow boosts efficiency and power delivery for all applications.



## WORK SAFELY:

All CG-15 grinders feature soft start, kickback and jam monitoring with a **rapid (<2 sec) motor brake** actuation. Paddle switch models also feature a lanyard eyelet for fall protection.

## CG 15 SLIDE SWITCH SERIES - 13 AMP

- + Brushless FEIN PowerDrive Motor
- + Slide switch models
- + Solid metal drive head rotates in 90° increments, no plastic components
- + Anti-vibration handle
- + 5" model [3,800 - 9,000 RPM] and 6" models [2,800 - 7,000 RPM]
- + INOX models - 2,800-7,000 RPM



**CG 15-125 BL**  
5" slide switch grinder  
**PART NUMBER:**  
72226760120



**CG 15-125 BL INOX**  
5" slide switch grinder  
**PART NUMBER:**  
72228660120



**CG 15-150 BL**  
6" slide switch grinder  
**PART NUMBER:**  
72227860120

## CG 15 PADDLE SWITCH SERIES - 13 AMP

- + Brushless FEIN PowerDrive Motor
- + Paddle switch models
- + Solid metal drive head rotates in 90° increments, no plastic components
- + Anti-vibration handle
- + 5" model [3,800 - 9,000 RPM] and 6" models [2,800 - 7,000 RPM]
- + INOX models - 2,800-7,000 RPM
- + Lanyard hook included



**CG 15-125 BLP**  
5" paddle switch grinder  
**PART NUMBER:**  
72227660120



**CG 15-125 BLP INOX**  
5" paddle switch grinder  
**PART NUMBER:**  
72228560120



**CG 15-150 BLP**  
6" paddle switch grinder  
**PART NUMBER:**  
72227760120

# CORDLESS ANGLE GRINDERS

Durability and portability make the NEW AMPShare cordless angle grinders with FEIN's powerful, fully encapsulated motors and variable speed control the perfect tools for any application.

AVAILABLE  
JANUARY  
2024

## CCG-18 BL SERIES SLIDE SWITCH

- + Encapsulated, dust-proof and maintenance free, variable speed brushless motors
- + Solid metal drive head rotates in 90° increments
- + Anti-vibration, soft start, restart protection, overload protection and safety brake
- + LED light for clear vision of workpiece
- + Variable speed, 2,500 - 8,500 RPM



**CCG 18-125 BL AS  
SELECT**  
5" slide switch grinder  
**PART NUMBER:**  
71220260120



**CCG 18-125 BL AS**  
5" slide switch grinder  
**PART NUMBER:**  
71220262120

MADE IN  
GERMANY

AVAILABLE  
JANUARY  
2024

## CCG-18 BLPD SERIES PADDLE SWITCH

- + Encapsulated, dust-proof and maintenance free, variable speed brushless motors
- + Paddle switch with dead-man function
- + Solid metal drive head rotates in 90° increments
- + Anti-vibration, soft start, restart protection, overload protection and safety brake
- + LED light for clear vision of workpiece
- + Variable speed, 2,500 - 8,500 RPM



**CCG 18-125 BLPD AS  
SELECT**  
5" paddle switch grinder  
**PART NUMBER:**  
71220460120



**CCG 18-125 BLPD AS**  
5" paddle switch grinder  
**PART NUMBER:**  
71220462120

AVAILABLE  
JANUARY  
2024

## AGSZ 18 CORDLESS DIE GRINDERS

- + Extended reach grinding
- + Variable speed
- + Motor and electronics protected against metal dust
- + Ideal for stainless and structural steel



**AGSZ 18-280 BL AS SELECT**  
**PART NUMBER:** 71230461090



**AGSZ 18-280 LBL AS SELECT**  
**PART NUMBER:** 71230561090



**AGSZ 18-90 LBL AS SELECT**  
**PART NUMBER:** 71230661090

MADE IN  
GERMANY



# DIE GRINDERS

Difficult-to-reach areas are now easily accessible with FEIN's die grinders. Each die grinder features FEIN's fully encapsulated and brushless PowerDrive motor. With its variable speed control, RPM's can be adjusted to specific applications.

**MADE IN GERMANY**

## **GSZ 8 DIE GRINDER - 750W**

- + Fits in difficult-to-reach spots
- + Motor and electronics protected against metal dust
- + Ideal for stainless and structural steel



**GSZ 8-280 P**  
PART NUMBER: 72231660090



**GSZ 8-280 PE**  
PART NUMBER: 72231760090

## **GSZ 4 LONG REACH DIE GRINDER - 350W**

- + Extended reach grinding
- + Variable speed
- + Motor and electronics protected against metal dust
- + Ideal for stainless and structural steel



**GSZ 4-280 EL**  
PART NUMBER: 72232460090



**GSZ 4-90 EL**  
PART NUMBER: 72232560090

## **GSZ 8 LONG REACH DIE GRINDER - 750W**

- + Extended reach grinding
- + Variable speed
- + Motor and electronics protected against metal dust
- + Ideal for stainless and structural steel



**GSZ 8-280 PEL**  
PART NUMBER: 72231960090



**GSZ 8-90 PEL**  
PART NUMBER: 72232060090

## **GSZ 11 LONG REACH RAT TAIL DIE GRINDER - 1,010W**

- + Extended reach grinding
- + Variable speed
- + Motor and electronics protected against metal dust
- + Ideal for stainless and structural steel
- + Rat tail grip provides an ergonomic fit for better control and comfort.



**GSZ 11-320 PERL**  
PART NUMBER: 72232260090



**GSZ 11-90 PERL**  
PART NUMBER: 72232360090

# METAL CUTTING SAWS

Slugger by FEIN metal cutting saws are built to stand up to whatever you can throw at them. With heavy-duty construction, heat free cutting and features that promote productivity and safety, it's no wonder Slugger by FEIN metal cutting saws are what the professionals use.

## 7-1/4" METAL CUTTING SAW

**PART NUMBER:** 69908120000

- + 2-1/2" maximum cutting depth
- + Bevel cut up to 45 degrees
- + Leaves a workable edge when cutting steel plate, square tube, angle, pipe & tube
- + Integrated laser guide makes precise cuts simple
- + Durable 1.9 hp motor to tackle most common jobs
- + Integrated chip collection keeps your job site clean

7-1/4" Saw Capacities	
Mild Steel	5/16"
Aluminum	3/8"
Stainless Steel	1/4"



## 9" METAL CUTTING SAW

**PART NUMBER:** 69908120001

- + LED work light & laser guide for straight, accurate cuts
- + Worm drive and oil bath gearbox makes for a longer lasting tool when cutting larger stock
- + Capable 2.4 hp motor provides more power when you need it
- + Quick release depth adjustment for plunge cuts
- + 3-3/8" maximum cutting depth
- + Cutting surfaces are cool to the touch, allowing you to work faster and safer
- + Integrated chip collection keeps your job site clean

9" Saw Capacities	
Mild Steel	1/2"
Aluminum	5/8"
Stainless Steel	5/16"



## 14" METAL CUTTING SAW

**PART NUMBER:** 72905361120

- + Easy, out-of-the-box setup
- + Rock solid design delivers less vibration for smooth clean cuts
- + Smooth clamp adjustments to quickly go from one job to the next
- + 5-1/8" maximum cutting depth
- + Chip collection tray keeps your job site clean
- + Cutting surfaces are cool to the touch, allowing you to work faster and safer
- + Depth stop allows you to consistently control your cut depth for reliable, precise cuts

14" Saw Capacities	
Mild Steel	1/2"
Aluminum	5/8"
Stainless Steel	5/16"





# METAL SAW BLADES

The Sluggerr by FEIN Metal saw blades are designed for fast and accurate cuts in mild & thin metal, aluminum and stainless steel. Compared to traditional abrasive-type blades, Sluggerr by FEIN metal saw blades perform faster, more accurate cuts, and maintain a lower temperature with less dust.

## 7" METAL SAW BLADES



Model	Part Number	Teeth	Arbor	Application
7" (180mm)	63502007500	36	3/4"	Mild steel up to 5/16" (8mm) solid material
	63502007510	54	3/4"	Aluminum up to 3/8" (9.5mm) solid material
	63502007520	48	3/4"	Stainless steel up to 1/4" (6mm) solid material
	63502007530	48	3/4"	Thin steel up to 1/4" (6mm) solid material

## 7-1/4" & 8" METAL SAW BLADES



Model	Part Number	Teeth	Arbor	Application
7 1/4" (185mm)	63502007200	36	3/4"	Mild steel up to 5/16" (8mm) solid material
	63502007210	54	3/4"	Aluminum up to 3/8" (9.5mm) solid material
	63502007220	48	3/4"	Stainless steel up to 1/4" (6mm) solid material
	69908120450	48	3/4"	Thin steel up to 1/4" (6mm) solid material
8" (203mm)	69908120441	42	5/8"	Mild steel up to 5/16" (8mm) solid material

## 9" METAL SAW BLADES



Model	Part Number	Teeth	Arbor	Application
9" (230mm)	63502009540	48	1"	Mild steel up to 1/2" (12.7mm) solid material
	63502009550	60	1"	Aluminum up to 5/8" (15.9mm) solid material
	63502009560	60	1"	Stainless steel up to 5/16" (8mm) solid material
	69908120448	60	1"	Thin steel up to 1/4" (6mm) solid material

## 14" METAL SAW BLADES



Model	Part Number	Teeth	Arbor	Application
14" (355mm)	63502014600	66	1"	Mild steel up to 1/2" (12.7mm) solid material
	63502014610	80	1"	Aluminum up to 5/8" (15.9mm) solid material
	63502014620	90	1"	Stainless steel up to 5/16" (8mm) solid material
	63502014630	90	1"	Thin steel up to 1/4" (6mm) solid material

# NIBBLERS & SHEARS

Corrugated sheet metal, trapezoid sheet metal, steel plates, profiles or pipes – with FEIN, you always have the right cutting method at hand.

## BLK 1.3 CSE NIBBLER

**PART NUMBER:** 72324260120

- + Indexable cutting direction
- + Variable Speed motor
- + Up to 7.5ft/min cutting speed
- + Long life punch and die set
- + Extra long 16ft power cord

**Capacity:**

Mild steel up to 18 gauge (1.3mm)  
Stainless Steel up to 24 gauge (.6mm)



## BLK 1.6 E NIBBLER

**PART NUMBER:** 72323860120

- + Indexable cutting direction
- + Variable Speed motor
- + Up to 6.2ft/min cutting speed
- + Long life punch and die set
- + Extra long 16ft power cord

**Capacity:**

Mild steel up to 16 gauge (1.6mm)  
Stainless Steel up to 22 gauge (.75mm)



## NIBBLER ACCESSORIES

Part Number	Description
30109169030	5 Punch/1 Die set for BLK 1.3CSE
30109169009	1 Die for BLK 1.3 CSE
63602050000	1 Punch for BLK 1.3 CSE
63602048013	1 Punch/1 - Die set for 1.6E Nibbler
30109141003	1 Die for BLK 1.6E
63602048004	1 Punch for BLK 1.6E
92602071019	1 Profil-Set extension 160

## BLS 1.6 E SHEET METAL SHEAR

**PART NUMBER:** 72303461090

- + Engineered for distortion free cutting
- + Cuts straight lines and curves
- + Variable Speed motor
- + Design allows for full visibility of cutting line
- + 4 sided indexable cutting blades for long life
- + Extra long 16ft power cord

**Capacity:**

Mild steel up to 16 gauge (1.6mm)  
Stainless Steel up to 20 gauge (1.0mm) 20



## BSS 1.6 E SLITTING SHEAR

**PART NUMBER:** 72303161090

- + Engineered for distortion free cutting
- + Variable Speed motor
- + Design allows for full visibility of cutting line
- + Long life cutting blade
- + Extra long 16ft power cord

**Capacity:**

Mild steel up to 16 gauge (1.6mm)  
Stainless Steel up to 19 gauge (1.0mm)



## SHEAR ACCESSORIES

Part Number	Description
31308072000	BLS 1.6E standard shear replacement blade - single blade
31308153014	BSS 1.6E slitting shear Cutting bars - pair
31308152001	BSS 1.6E slitting shear Cutter blade (for Stainless steel up to .031" thickness)
31308123008	BSS 1.6E slitting shear Cutter blade (for Stainless steel up to .051" thickness)
31308151008	BSS 1.6E slitting shear Cutter blade (for mild steel up to .039" thickness)
31308150009	BSS 1.6E slitting shear Cutter blade (for mild steel up to .063" thickness)



### **BLK 3.5 E NIBBLER**

**PART NUMBER:** 72324661090

- + Cuts through grooves and cut-outs in sheet metals, tool can turn on the spot.
- + Adjustable cutting direction in three 90° steps
- + Chip protection mesh on vent slots

**Capacity:**

Mild steel up to 10 gauge (3.2mm)  
Stainless Steel up to 14 gauge (1.8mm)



### **BLK 5.0 NIBBLER**

**PART NUMBER:** 72323112634

- + Indexable cutting direction
- + Powerful 1,200W Motor
- + Up to 4.3ft/min cutting speed
- + Long life punch and die set
- + Extra long 16ft. Power Cord

**Capacity:**

Mild steel up to 6 gauge (5.0mm)  
Stainless Steel up to 13 gauge (2.5mm)

AVAILABLE  
**JANUARY**  
**2024**

## **AMPSHARE CORDLESS NIBBLERS AND SHEARS**



### **ABLK 18 1.3 CSE NIBBLER**

**KIT PART NUMBER:** 71320565090  
**SELECT PART NUMBER:** 71321061090

- + Indexable cutting direction
- + Variable Speed motor
- + Up to 7.5ft/min cutting speed
- + Long life punch and die set
- + Includes additional punch and die set (30109169030)

**Capacity:**

Mild steel up to 18 gauge (1.3mm)  
Stainless Steel up to 24 gauge (.6mm)



### **ABLK 18 1.6 E NIBBLER**

**KIT PART NUMBER:** 71320465090  
**SELECT PART NUMBER:** 71321161090

- + Indexable cutting direction
- + Variable Speed motor
- + Up to 6.2ft/min cutting speed
- + Long life punch and die set
- + Includes additional punch and die set (63602048013)

**Capacity:**

Mild steel up to 16 gauge (1.6mm)  
Stainless Steel up to 22 gauge (.75mm)



### **ABSS 18 1.6 E SLITTING SHEAR**

**KIT PART NUMBER:** 71300565090  
**SELECT PART NUMBER:** 71300661090

- + Cuts straight lines and curves
- + Variable Speed motor
- + Engineered for distortion free cutting
- + Design allows for full visibility of cutting line
- + Long life cutting blade
- + Includes additional cutting blade (31308151008)

**Capacity:**

Mild steel up to 16 gauge (1.6mm)  
Stainless Steel up to 19 gauge (1.0mm)



### **ABLS 18 1.6 E SHEET METAL SHEAR**

**KIT PART NUMBER:** 71300665090  
**SELECT PART NUMBER:** 71300561090

- + Cuts straight lines and curves
- + Variable Speed motor
- + Engineered for distortion free cutting
- + Design allows for full visibility of cutting line
- + 4 sided indexable cutting blades for long life
- + Includes additional cutting insert (31308072000)

**Capacity:**

Mild steel up to 16 gauge (1.6mm)  
Stainless Steel up to 19 gauge (1.0mm)

**\*\*All nibbler and shear sets contain (2) 4Ah CORE 18V batteries, (1) Rapid charger (92604334010), (1) marker and (1) roll of tape.\*\***

# VERSAMAG

Boost productivity and increase jobsite safety by taking the vise wherever you need it.

**NEW!**



## MANEUVERABILITY IN MIND

Strong Permanent Magnet provides 1,750lb holding force on 1" steel plate. Magnet can also be easily adjusted.

## ALL METAL CONSTRUCTION

Multi-function jaw quickly grips workpieces safely. Large 4.25" jaw capacity.

## PRECISION

Machined surface provides smooth jaw action while clamping.



**ON** position provides **100%** holding force

**30%** hold for quick vise positioning.



## EASY TO OPERATE

Tool-free set up with everything you need stored on VersaMAG.

TECHNICAL DATA	VersaMAG permanent magnet with vise
JAW HEIGHT (IN)	1.57"
CLAMPING WIDTH (IN)	4.25"
MAGNETIC FOOT DIMENSIONS (IN)	8.35" x 2.75"
MAGNETIC HOLDING FORCE (LBF.)	1,750
WEIGHT (LBS)	16
JAW WIDTH (IN)	3.94"
INCLUDES	1x permanent magnet, 1x vise, 1x socket head wrench (3 mm), 1x safety strap
PART NUMBER	90701004020



## VersaMAG ACCESSORIES



### 2-1/3 inch oversized jaw for FEIN VersaMAG

**PART NUMBER: 32422420010**

Perfect for machining larger flat and round materials with a diameter of up to 4 inches. Only compatible with the FEIN VersaMAG vise.



### Welding plate for FEIN VersaMAG

**PART NUMBER: 90701005020**

Long-life welding plate with a hole diameter of 5/8in. on a 10 x 10in. plate. Plasmatized product for good surface protection, also features a prefabricated drill pattern for Demmeler and Siegmund elements. Only compatible with the FEIN VersaMAG.

# HAND HELD DRILLS

FEIN is known worldwide for its quality and dependable drilling solutions. We have one of the best selections of corded drills on the market today.

**MADE IN GERMANY**

## **BOP 10** HAND DRILL

**PART NUMBER:** 72055360090

- + Precision, all metal 3/8" 3-jaw chuck
- + Reversible
- + FEIN high performance motor with speed stability for constant drilling
- + Adjustable handle
- + Extra long 16ft power cord



## **BOP 13-2** HAND DRILL

**PART NUMBER:** 72055560090

- + Precision, all metal 1/2" 3-jaw chuck
- + Mechanical, 2-speed gearbox with speed adjustment
- + Reversible
- + FEIN high performance motor with speed stability for constant drilling
- + Adjustable handle
- + Extra long 16ft power cord



## **BOS 16** HAND DRILL

**PART NUMBER:** 72054760090

- + Precision, all metal 5/8" 3-jaw chuck
- + Reversible
- + FEIN high performance motor with speed stability for constant drilling
- + Adjustable handle
- + Extra long 16ft power cord



## **BOS 16-2** HAND DRILL

**PART NUMBER:** 72054960090

- + Precision, all metal 5/8" 3-jaw chuck
- + Mechanical, 2-speed gearbox with speed adjustment
- + Reversible
- + FEIN high performance motor with speed stability for constant drilling
- + Adjustable handle
- + Extra long 16ft power cord



# MAG DRILLS



Slugger by FEIN offers more magnetic base drills for more applications, providing the right tool for every job. All Slugger by FEIN magnetic base drills reduce downtime with 100% duty cycle, high-performance, high torque motors.

## ENDURANCE DRILLS

Maximum durability and portability make the Slugger Endurance series magnetic base drills the ultimate drills for any heavy drilling situation. Quality, superior durability and essential functionality, these drills are more than capable of handling any drilling task.

- + High performance, 100% duty cycle motors designed for all day hole making.
- + Lightweight, ergonomic drill stands.
- + Easily accessible controls for motor and magnet.
- + Feed handle can be changed to either side.
- + Drill chuck and countersink accessories available.

**NEW!**



### **JME SHORTSLUGGER II**

**PART NUMBER:** 72709461090

- + Extra-durable gearbox design with up to 400 hours of operation time
- + Internal motor cord
- + Tilt sensor safety shut off
- + Coolant tank included
- Capacity:** 1-1/4" x 2"
- Stroke length:** 3-9/16"
- Weight:** 23.8 lb
- Recommended Cutters:** HSS



### **JME HOLEMAKER III**

**PART NUMBER:** 72705961090

- + Optimal RPM's for both HSS and Carbide cutters
- + Double dovetail design for use with longer tooling
- + Pivoting motor cable
- + Coolant tank included
- Capacity:** 1-3/8" x 2"
- Stroke length:** 5-11/16"
- Stroke range:** 10-1/4"
- Weight:** 25.8 lb
- Recommended Cutters:** HSS/Carbide



### **JHM USA 101**

**PART NUMBER:** 72725261124

- + Solid die-cast aluminum construction
- + Smart magnet safety circuitry
- + Uniform torque motor ideal for HSS cutters
- + Positive slug ejection
- + Coolant tank included
- Capacity:** 1-1/2" x 2"
- Stroke length:** 2-9/16"
- Weight:** 31.75 lb
- Recommended Cutters:** HSS



### **JME USA 202 M**

**PART NUMBER:** 72706961090

- + Mechanical 2-speed gearbox
- + Optimal for both HSS and Carbide
- + Pivoting motor cable
- + Coolant tank included
- Capacity:** 2" x 2"
- Stroke length:** 5-5/16"
- Stroke range:** 10-1/4"
- Weight:** 30.9 lb
- Recommended Cutters:** HSS/Carbide

## UNIVERSAL DRILLS

Universal drills with functionality in mind and outstanding performance with quality and technology to boot. The Sluggerr Universal series magnetic base drill series offers the precision tools needed to complete any job with repeatability and consistency.

- + High performance, 100% duty cycle motors designed for all day hole making.
- + Lightweight, ergonomic drill stands.
- + Universal functionality for drilling, tapping, reaming and countersinking.
- + Double dovetail design for longer tooling.



### JMU 137-2 QW

**PART NUMBER:** 72705861120

- + Tilt sensor safety shutoff
- + Mechanical 2 speed gearbox designed for small twist drills and annular cutters
- + Electronic speed and reversing motor controls
- + Coolant tank included
- Capacity:** 1-3/8" x 2"
- Stroke length:** 5-5/16"
- Stroke range:** 10-1/4"
- Weight:** 23.6 lb
- Recommended Cutters:** HSS/Carbide



### JMU 137 PQW

**PART NUMBER:** 72707361090

- + Tilt sensor safety shut off
- + Permanent magnet
- + Electronic speed and reversing motor controls
- + Coolant tank included
- Capacity:** 1-1/2" x 2"
- Stroke length:** 5-5/16"
- Stroke range:** 10-1/4"
- Weight:** 27.5 lb
- Recommended Cutters:** HSS/Carbide



### JCM 200 U

**PART NUMBER:** 72704461120

- + Extra large stroke for all drilling work
- + High-power motor with stable speed
- + Electronic speed and reversing motor controls
- + Coolant tank included
- Capacity:** 2" x 2"
- Stroke length:** 5-11/16"
- Stroke range:** 12-3/8"
- Weight:** 32.1 lb
- Recommended Cutters:** Carbide



### JCM 256 U

**PART NUMBER:** 72704761120

- + Extra large stroke for all drilling work
- + High-power motor with stable speed
- + Electronic speed and reversing motor controls
- + Coolant tank included
- Capacity:** 2-9/16" x 2"
- Stroke length:** 5-11/16"
- Stroke range:** 12-3/8"
- Swivel base:** 7 degrees
- Weight:** 36.75 lb
- Recommended Cutters:** Carbide



### JMU 404 M

**PART NUMBER:** 72706061090

- + Mechanical 4-speed gearbox
- + FEIN 1,700 W high-performance, high torque motor
- + Torque slip clutch
- + Coolant tank included
- Capacity:** 4-5/16" x 4"
- Stroke length:** 11"
- Stroke range:** 15-3/4"
- Weight:** 79.4 lb
- Recommended Cutters:** HSS/Carbide

# SPECIALTY MAG DRILLS



Slugger by FEIN offers more magnetic base drills for more applications, providing the right tool for every job. All Slugger by FEIN magnetic base drills reduce downtime with 100% duty cycle, high-performance, high torque motors.

## COMPACT DRILLS

Compact and adaptable, the perfect workhorse for tight spaces that need precise results. Where other magnetic drills just can't fit, the Compact series is there to get even the tightest job done.

**NEW!**



### JMC MAGFORCE 90

**PART NUMBER:** 72732362090

- + Smallest magnetic base drill with forward/reverse rotation
  - + Powerful 1,150 watt brushless motor
  - + Tilt sensor safety shutoff
  - + Ratcheting handle allows work in even the tightest places
  - + Coolant bottle included
- Capacity:** 1-3/8" x 1-3/8"  
**Stroke length:** 1-13/16"  
**Weight:** 18.75 lb  
**Recommended Cutters:** HSS/Carbide



### JHM MAGFORCE

**PART NUMBER:** 72725361127

- + Compact with ideal power to weight ratio for work in small spaces
  - + Stationary drill motor with positive slug ejection
  - + Solid die-cast aluminum construction
  - + Smart magnet safety circuitry
  - + Coolant tank included
- Capacity:** 1-5/8" x 2"  
**Stroke length:** 2-9/16"  
**Weight:** 28.8 lb  
**Recommended Cutters:** HSS/Carbide

## AUTOMATIC DRILLS

Save time and money while getting precise, repeatable results with the automatic drilling functionality of the Automatic series drills.



### JCM 200 AUTO

**PART NUMBER:** 72704661120

- + Tilt sensor safety shutoff
  - + Mechanical 2-gearbox
  - + Repeatable and consistent drilling times
  - + Coolant tank included
- Capacity:** 2" x 2"  
**Stroke length:** 5-11/16"  
**Stroke range:** 12-3/8"  
**Weight:** 35.7 lb  
**Recommended Cutters:** Carbide

## CORDLESS DRILL

Speed and efficiency meet portability with the Slugger Cordless series. The cordless line offers the same quality and performance as its corded variants but in a convenient, manageable drill.



### AJMU 137 PMQW

**PART NUMBER:** 71700261090

- + Powerful and lightweight FEIN Power Drive brushless motor and FEIN HighPower battery
  - + Permanent magnet
  - + Universal functionality for drilling, tapping, reaming and countersinking
  - + Coolant tank included
- Capacity:** 1-3/8" x 2"  
**Stroke length:** 5-5/16"  
**Stroke range:** 10-1/4"  
**Weight (w/o battery):** 26.7 lb  
**Recommended Cutters:** HSS/Carbide

## MAG DRILL ACCESSORIES

Part Number	Description
64201002980	Slugger by FEIN Magbrush - 15" Reach
64201003980	Slugger by FEIN Magbrush - 36" Reach
64298190100	1/2" chuck and adapter for USA-101
69908195346	1/2" Drill Chuck with 3/4" straight shank For all drills except: ShortSlugger II, MagForce, MagForce90
69908195275	5/8" Drill chuck with 3/4" straight shank For all drills except: ShortSlugger II, MagForce, MagForce90
Cutting Fluid & Paste	
32132032980	Slugger by FEIN Cutting Fluid - 1 Qt. bottle
32160015980	Slugger by FEIN Cutting Paste - 10 oz. Tube
64298102080	Slugger by FEIN Cutting Fluid - 1 Gallon bottle
32132032982	Cutting fluid (12 qt case)
64298102084	Cutting fluid (4 gal case)
64298102090	Cutting fluid (5 gal bucket)
32160015982	Slugger cutting paste (12 - 10oz tubes)



## ARBOR EXTENSIONS

Arbor body diameter is 1-5/16"



Part Number	Description
63106020980	2" arbor extension
63106021980	3" arbor extension
63106022980	4" arbor extension
63106023980	6" arbor extension

## SUCTION PLATE

Part Number	Description
92602054016	For non-magnetic materials, 9-3/16 x 13 x 4-5/16 in [250 x 330 x 110 mm].



## PIPE DRILLING DEVICE

Part Number	Description
92602055010	Including clamping strap, for drilling holes in pipe with Ø from 2-3/8 to 11-13/16 in [60 to 300 mm], 8-11/16 x 5-1/8 in [220 x 130 mm] including suction hose.





# MAG DRILL CUTTERS

Slugger annular cutters, combined with Slugger magnetic base drills, create a cost-effective, high-performance system.

## HIGH SPEED STEEL CUTTERS



### HELICAL FLUTE DESIGN

Wide flutes reliably evacuate the chips out of the hole. Fast, efficient chip removal with minimum contact between the cutter and drill hole for low torque and power consumption.

### HIGH PERFORMANCE

All cutting teeth have the same geometry which helps to produce clean, burr-free holes while still allowing for a fast, smooth cut.

### INDUSTRY STANDARD

2 flat 3/4 in straight shank for use with most commercially available magnetic drills.

### 100% HEAT TREATED THROUGHOUT

Internal vacuum heat treatment for consistent performance and longer service life. Cutters can also be resharpened up to 6 times.

Description	1" DOC	2" DOC
7/16" HSS with pilot pin	63134111041	63134111042
1/2" HSS with pilot pin	63134127041	63134124042
9/16" HSS with pilot pin	63134143041	63134143042
5/8" HSS with pilot pin	63134158041	63134158042
11/16" HSS with pilot pin	63134175041	63134175042
3/4" HSS with pilot pin	63134191041	63134191042
13/16" HSS with pilot pin	63134206041	63134206042
7/8" HSS with pilot pin	63134222041	63134222042
15/16" HSS with pilot pin	63131238041	63134238042
1" HSS with pilot pin	63134254041	63134254042
1-1/16" HSS with pilot pin	63134269041	63134269042
1-1/8" HSS with pilot pin	63134286041	63134286042
1-3/16" HSS with pilot pin	63134302041	63134302042
1-1/4" HSS with pilot pin	63134318041	63134318042
1-5/16" HSS with pilot pin	63134333041	63134333042
1-3/8" HSS with pilot pin	63134349041	63134349042
1-7/16" HSS with pilot pin	63134365041	63134365042
1-1/2" HSS with pilot pin	63134381041	63134381042
1-9/16" HSS with pilot pin	63134397041	63134397042
1-5/8" HSS with pilot pin	63134413041	63134413042
1-11/16" HSS with pilot pin	63134429041	63134429042
1-3/4" HSS with pilot pin	63134445041	63134445042
1-13/16" HSS with pilot pin	63134460041	63134460042
1-7/8" HSS with pilot pin	63134476041	63134476042
1-15/16" HSS with pilot pin	63134492041	63134492042
2" HSS with pilot pin	63134508041	63134508042
2-1/16" HSS with pilot pin	63134524041	63134524042



## HIGH SPEED STEEL ID GRIND WITH TIN COATING CUTTERS\*

Description	1" DOC
9/16" IDTN	63134142113
5/8" IDTN	63134158106
11/16" IDTN	63134174119
3/4" IDTN	63134190109

Description	1" DOC
7/8" IDTN	63134222107
15/16" IDTN	63134238115
1" IDTN	63134254108

\*1" DOC ID TIN coated cutters do not come with a pilot pin. Pilot pin needed, PN 63134998300



## CARBIDE CUTTERS



### HELICAL FLUTE DESIGN

Wide flutes reliably evacuate the chips out of the hole. Fast, efficient chip removal with minimum contact between the cutter and drill hole for low torque and power consumption.

### DESIGNED FOR DRILLING AT HIGHER RPM'S

Allowing you to make more holes much faster.

### UNIVERSAL SHANK

2 flat 3/4 in straight shank with dentents for use with most commercially available magnetic drills.

### DURABILITY

All cutting teeth have the same geometry which helps to produce clean, burr-free holes. Carbide makes for a longer lasting cutter and is ideal for harder materials and higher RPMs.

Description	1" DOC*	1-3/8" DOC	2" DOC
9/16" Carbide Cutter with pilot pin	63127561110*	63135143021	63135143022
5/8" Carbide Cutter with pilot pin	63127562110*	63135159021	63135159022
11/16" Carbide Cutter with pilot pin	63127563110*	63135175021	63135175022
3/4" Carbide Cutter with pilot pin	63127564110*	63135191021	63135191022
13/16" Carbide Cutter with pilot pin	63127565110*	63135206021	63135206022
7/8" Carbide Cutter with pilot pin	63127566110*	63135222021	63135222022
15/16" Carbide Cutter with pilot pin	63127567110*	63135238021	63135238022
1" Carbide Cutter with pilot pin	63127568110*	63135254021	63135254022
1-1/16" Carbide Cutter with pilot pin	63127569110*	63135269021	63135269022
1-1/8" Carbide Cutter with pilot pin	63127570110*	63135286021	63135286022
1-3/16" Carbide Cutter with pilot pin	63127571110*	63135302021	63135302022
1-1/4" Carbide Cutter with pilot pin	63127572110*	63135318021	63135318022
1-5/16" Carbide Cutter with pilot pin	63127573110*	63135333021	63135333022
1-3/8" Carbide Cutter with pilot pin	63127574110*	63135349021	63135349022
1-7/16" Carbide Cutter with pilot pin	-	63135365021	63135365022
1-1/2" Carbide Cutter with pilot pin	-	63135381021	63135381022
1-9/16" Carbide Cutter with pilot pin	-	63135397021	63135397022
1-5/8" Carbide Cutter with pilot pin	-	63135413021	63135413022
1-11/16" Carbide Cutter with pilot pin	-	63135429021	63135429022
1-3/4" Carbide Cutter with pilot pin	-	63135445021	63135445022
1-13/16" Carbide Cutter with pilot pin	-	63135461021	63135461022
1-7/8" Carbide Cutter with pilot pin	-	63135476021	63135476022
1-15/16" Carbide Cutter with pilot pin	-	63135492021	63135492022
2" Carbide Cutter with pilot pin	-	63135508021	63135508022
2-1/16" Carbide Cutter with pilot pin	-	63135524021	63135524022

\*1" DOC TCT do not come with a pilot pin. Pilot pin needed, PN: 63134998300



## TWIST DRILL SETS - 3/4 STRAIGHT SHANK

Description	2" DOC
Standard set, 1/4", 5/16", 3/8", 7/16"	64298050000
1/4"	64298050020
5/16"	64298050040
3/8"	64298050030
7/16"	64298050050

Description	1-3/8" DOC
1/4"	63111029010
3/8"	63111030010
5/16"	63111031010
7/16"	63111032010
9/16"	63111033010

# MAG DRILL CUTTERS



Slugger annular cutters, combined with Slugger magnetic base drills, create a cost-effective, high-performance system.

## SLUGGER CUTTER SETS

**Find the cutter set that works for you.** With Slugger's dynamic cutter offerings, coupled with the unmatched quality and durability of Slugger magnetic base drills, finding the right combination for any job has never been easier.

**NEW!**



**5 piece universal shank carbide cutter set - 2" DOC**  
**PART NUMBER:** 63135999010  
 3/4" shankset includes diameters: 9/16", 11/16", 13/16", 15/16", 1-1/16". Includes case, pilot pin.



**5 piece HSS structural cutter set 1" DOC**  
**PART NUMBER:** 63134999010  
 3/4" shankset includes diameters: 9/16", 11/16", 13/16", 15/16", 1-1/16". Includes case, pilot pin.



**5 piece HSS Structural cutter set 2" DOC**  
**PART NUMBER:** 63134999015  
 3/4" shank set includes diameters: 9/16", 11/16", 13/16", 15/16", 1-1/16". Includes case, pilot pin.



**11 piece HSS 1" DOC cutter set (7/16" - 1-1/16")**  
**PART NUMBER:** 63134999020  
 3/4" shankset includes diameters: 7/16", 1/2", 9/16", 5/8", 11/16", 13/16", 3/4", 13/16", 7/8", 15/16", 1", 1-1/16". Includes pilot pin for 7/16" to 1/2" cutter Ø, pilot pin for 9/16" to 1-1/16" cutter Ø, case.



**11 piece HSS 2" DOC cutter set (7/16" - 1-1/16")**  
**PART NUMBER:** 63134999026  
 3/4" shank set includes diameters: 7/16", 1/2", 9/16", 5/8", 11/16", 13/16", 3/4", 13/16", 7/8", 15/16", 1", 1-1/16". Includes pilot pin for 7/16" to 1/2" cutter Ø, pilot pin for 9/16" to 1-1/16" cutter Ø, case.

## APPLICATION & MACHINE SELECTION

	HSS CUTTERS	CARBIDE CUTTERS
QUICK COMPARISON	<ul style="list-style-type: none"> <li>+ General fabrication</li> <li>+ Can be resharpened up to 6 times.</li> <li>+ Lowest cost per hole &lt; 1-1/8" Ø</li> </ul>	<ul style="list-style-type: none"> <li>+ General/structural, stainless steel and exotic metals</li> <li>+ Lowest cost per hole &gt; 1-1/8" Ø</li> <li>+ Faster cut**</li> </ul>
RECOMMENDED MACHINES All drills run HSS & carbide	<ul style="list-style-type: none"> <li>+ ShortSlugger II</li> <li>+ MagForce 90</li> <li>+ USA 101</li> </ul>	<ul style="list-style-type: none"> <li>+ JMU 137 series</li> </ul>
COMPETITOR MACHINES	<ul style="list-style-type: none"> <li>+ Slugger cutters use an industry standard 3/4" straight shank.</li> <li>+ Will fit most competitor machines**</li> </ul>	<ul style="list-style-type: none"> <li>+ Holemaker III</li> <li>+ USA 202</li> <li>+ JMC Magforce 90</li> <li>+ JMU 404 M</li> <li>+ JCM 200 U</li> <li>+ JCM 256U</li> </ul>

# SLUGGER BY FEIN ANNULAR CUTTERS



With over 40 years of annular cutter manufacturing and design experience, we are the industry experts in hole-making. Our annular cutters are not only made in the USA, they are 3-4x faster and more precise than twist drilling, and leave smooth, burr-free holes. And because our cutters are high quality and able to be resharpened, they last longer, resulting in a lower cost per hole for you.



## WHEN YOU BUY SLUGGER BY FEIN, YOU DEAL DIRECTLY WITH THE MANUFACTURER.

Slugger by FEIN stocks the largest, most varied offering of annular cutters sizes. If we don't stock what you need, we can produce it.

### Custom cutters for any specialty application:

- + Ranging from 7/16" – 4" in diameter
- + Ranging from 1/2" – 6" depth of cut
- + Non-standard geometries
- + Specialty coatings
- + Non-Standard shank sizes and shapes
- + Cutters with special wall thickness

\*Minimum order quantity: 6. Shipment depends on custom cutter requirements.



#### High Speed Steel Cutters (HSS)

- + Standard material used to manufacture Slugger cutters.
- + Ideal for drilling structural steel.



#### High Speed Steel Cutters (ID Geometry)

- + Convenient when drilling through multiple layers.



#### High Speed Steel Cutters (Titanium Nitride)

- + Improves tools life by increasing surface hardness of tool, providing greater lubricity.



#### High Speed Steel Cutters (Titanium Nitride, cobalt steel cutters)

- + Improve tool life by increasing surface hardness of the tool and providing greater lubricity.



#### High Speed Steel Cutters (Titanium Carbonitride, coated)

- + Practical when drilling highly abrasive or gummy materials, such as brass and aluminium alloys.



#### Cobalt Steel Cutters (M42)

- + Efficient when drilling materials are inconsistent.
- + Contain the highest amount of cobalt.
- + Extending tool life between sharpening.



#### Universal Shank Carbide Cutters

- + Ideal for cutting harder materials.
- + Designed for drilling higher RPM'S when increased hole making is desired.



FEIN is the specialist for professional and extremely reliable power tools and special application solutions in the metal, interior and automotive sectors. As the inventor of the electric hand drill, FEIN has been developing innovative and unbeatably efficient solutions for everyday use which can also stand up to the toughest continuous use in industry and trade for over 150 years.



Quick registration – extended warranty period:  
The 3-year FEIN PLUS warranty.

We offer the 3-year FEIN PLUS warranty for all your FEIN power tools. All you need to do is register your new FEIN product at [www.fein.com/warranty](http://www.fein.com/warranty) within 3 months of purchase.

FEIN US  
FEIN Power Tools Inc.  
1000 Omega Drive,  
Suite 1180, Pittsburgh, PA 15205  
Toll Free: 1-800-441-9878  
[www.feinus.com](http://www.feinus.com)

Printed in the US. Product images are for illustrative purposes only. Technical details subject to change. PN: 69908112182 11.2023 US

